



STRUCTURE TENT

WE STRUCTURE THE WORLD



tentx.com.mx

Villa Series K1



Truss Profile:
4"x2"
100x48x3 mm

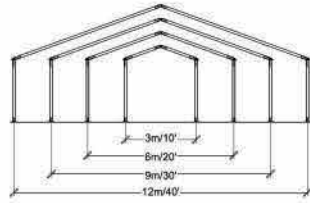

Villa Series K1 Pagoda



Truss Profile:
4"x2"
100x48x3 mm

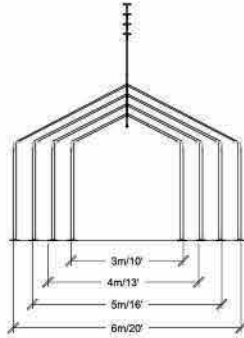

Villa Series K2



Truss Profile:
4 3/4"x2"
120x48x3x5.5mm

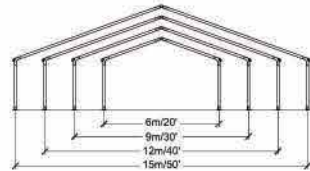

Temple Series K3



Truss Profile:
6 1/2"x3 1/2"
166x88x3x3.5mm

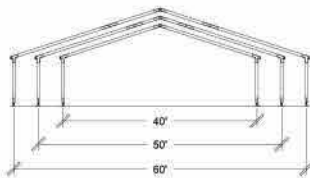

Temple Series K4



Truss Profile:
6"x4 3/4"
150x120x3x4 mm

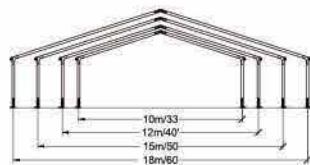

Forum Series K5

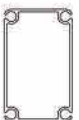

Truss Profile:
7 3/4"x4 3/4"
200x120x4x5 mm

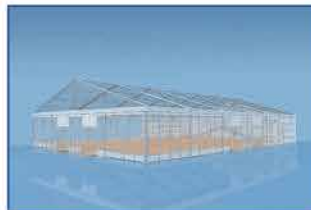
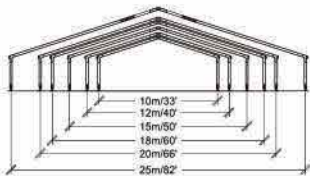

Forum Series K6



Truss Profile:
 9 3/4"×4 3/4"
 250×120×4×6 mm

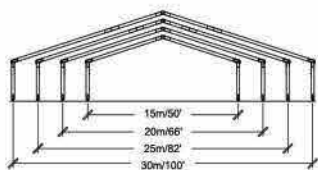

Arena Series K7



Truss Profile:
 11 3/4"×4 3/4"
 300×120×5×7 mm

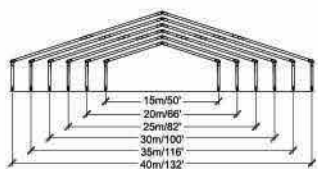

Arena Series K8

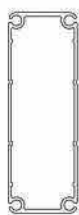

Truss Profile:
 13 3/4"×4 3/4"
 350×120×5×7 mm

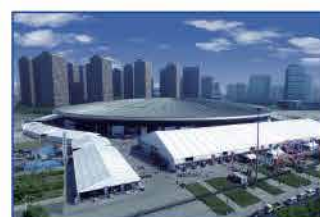
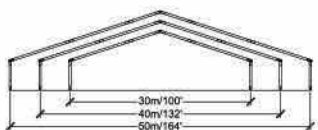

Stadia Series K9

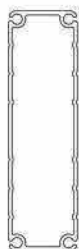

Truss Profile:
 16 1/2"×4 3/4"
 420×120×6×8 mm

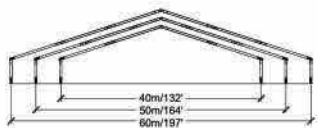

Stadia Series K10



Truss Profile:
 19 3/4"×6"
 500×150×6.2×8.8 mm

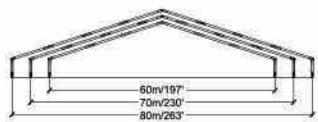

Product data sheet: Frame Identification Chart

Type	Profile	Truss Profile	Width	Leg (cm)	Bay Distance	Rafter Section	
						Standard	Optional
Villa Series	K1	4"x2" 100x48x3 mm	3m	250/300	3m/10'	1.5m	—
			6m	250/300		3.0m	—
			9m	250/300		4.5m	3.0m+1.5m
			12m	250/300		6.0m	4.5m+1.5m
	K1 Pagoda	4"x2" 100x48x3 mm	3mx3m	250		—	—
			4mx4m	250		—	—
			5mx5m	250		—	—
			6mx6m	250		—	—
	K2	4 3/4"x2" 120x48x3x5.5mm	6m	250/300	3m/10'	3.0m	—
			9m	250/300		4.5m	—
			12m	250/300		6.0m	3.0m+3.0m
			15m	250		7.5m	4.5m+3.0m
Temple Series	K3	6 1/2"x3 1/2" 166x88x3x3.5mm	40'	10'	15'	20'	—
			50'	10'		20'+5'	—
			60'	10'		20'+10'	—
	K4	6"x4 3/4" 150x120x3x4 mm	10m	300	5m/16'	5.0m	—
			12m	300		6.0m	—
			15m	300		7.5m	6.0m+1.5m
			18m	300		9.0m	6.0m+3.0m
	Forum Series	K5	7 3/4"x4 3/4" 200x120x4x5 mm	10m	300/400/500	5m/16'	5.0m
12m				300/400	6.0m		—
15m				300/400	7.5m		6.0m+1.5m
18m				300/400	9.0m		7.5m+1.5m
20m				300/400	10.0m		7.5m+2.5m
K6		9 3/4"x4 3/4" 250x120x4x6 mm	15m	400	5m/16'	10.0m+2.5m	7.5m+5.0m
			20m	400		7.5m	—
			25m	400		10.0m	—
			30m	400		10.0m+2.5m	7.5m+5.0m
						10.0m+5.0m	7.5m+7.5m
Arena Series	K7	11 3/4"x4 3/4" 300x120x5x7 mm	15m	400/500	5m/16'	7.5m	—
			20m	400/500		10.0m	7.5m+2.5m
			25m	400/500		10.0m+2.5m	7.5m+5.0m
			30m	400/500		10.0m+5.0m	7.5m+7.5m
			35m	400/500		10.0m+7.5m	—
	K8	13 3/4"x4 3/4" 350x120x5x7 mm	40m	400/500	5m/16'	10.0m+10.0m	—
			30m	400/500/600		10.0m+5.0m	—
			40m	400/500/600		10.0m+10.0m	—
			50m	400/500/600		10.0m+10.0m+5.0m	—
						10.0m+10.0m	—
Stadia Series	K9	16 1/2"x4 3/4" 420x120x6x8 mm	40m	400/500/600/700	5m/16'	10.0m+10.0m	—
			50m	400/500/600/700		10.0m+10.0m+5.0m	—
			60m	400/500/600/700		10.0m+10.0m+10.0m	—
	K10	19 3/4" x6" 500x150x6.2x8.8 mm	60m	500/600/700	5m/16'	10.0m+10.0m+10.0m	—
			70m	500/600		10.0m+10.0m+10.0m+5.0m	—
			80m	500/600		10.0m+10.0m+10.0m+10.0m	—

Widths:

3m=10' 4m=13' 5m=16' 6m=20' 9m=30' 10m=33'
 12m=40' 15m=50' 18m=60' 20m=66' 25m=82' 30m=100'
 35m=116' 40m=132' 50m=164' 60m=197' 70m=230' 80m=263'

Leg Height:



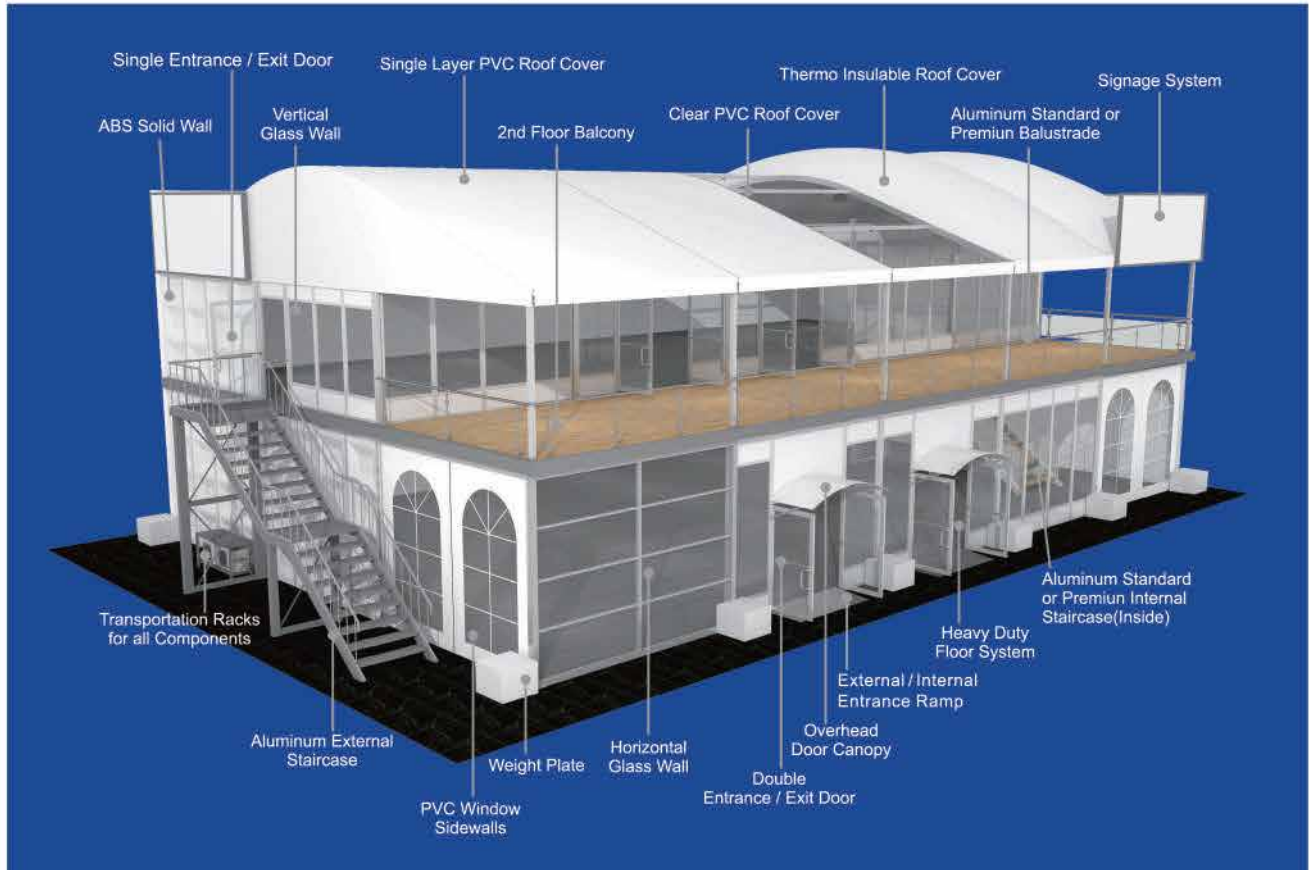

250cm=8' 300cm=10' 400cm=13' 500cm=16'
 600cm=20' 700cm=23'

Sizes are rounded
to the nearest foot/inch.

Optional Accessories

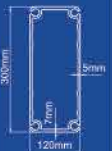

Double Decker Tent Technical Data

Framework main profile	Item	Specification
	Clear Span Width	A Frame Design: 10m/15m. Flat Roof Design: 20m/25m/30m.
 Main Profile  Main Profile (2nd floor)  Eave / Ridge Purlin	Side Height (1st Floor)	4m
	Eave Height	8m
	Ridge Height	A Frame Design: 9.7m//10.5m. Flat Frame Design: 9.4m/9.72m/10m.
 Gable Pole Purlin  Intermediate Purlin  Roof Tension Bar	Bay Distance	5m
	Wind Loading	115MPH
	Floor Loading Capacity	200kg/m ² ~450kg/m ²
	Roof Pitch	A Frame Design: 18° Flat Roof Design: 7°
	Main Profile	300x120x5x7mm
	Roof Options	Thermo Roof
	Roof Fixing	Bar Tensioning
	Eave Connection	Hot-dip Galvanized twin steel plate
	Framework Material	Hard pressed extruded aluminium alloy 6061/T6
	Cover Material	PVC-coated Polyester textile, Opaque, Water proof, 850g/m ² . Flame retardant





C. Alaska #2218, Las
Águilas. C.P. 31250,
Chihuahua, Chih.



Av. Prol. Teófilo Borunda
2001, Mirador. C.P. 31205
Chihuahua, Chih.

 ventas@tentx.com.mx

 (614) 441 4682

 (614) 108 3135

tentx.mx



www.tentx.mx